



The
**Property
Selling**
company™

Tel 0800 111 4118

Email hello@thepropertysellingcompany.co.uk

Web www.thepropertysellingcompany.co.uk



3 Pleydell Road, Swindon, SN1 4DJ

Offers over £489,950

We are pleased to present this lovely 4 bedroom detached property, Located a short walk from the heart of Old Town, this home would be perfect for a family looking to upsize or an investor looking to invest into property.

The property is in need of a little TLC, to the ground floor it consists of entrance hall leading to the large spacious living room with patio doors leading to the rear decking, a study/family room, kitchen/diner also has patio doors to the decking and has the added bonus of a utility room with WC with an internal door to the garage.

Upstairs consists of 4 bedrooms, main bedroom with an ensuite, storage on the landing and a family bathroom, the property has off street parking and a garage.

Call the office today to get a viewing!!



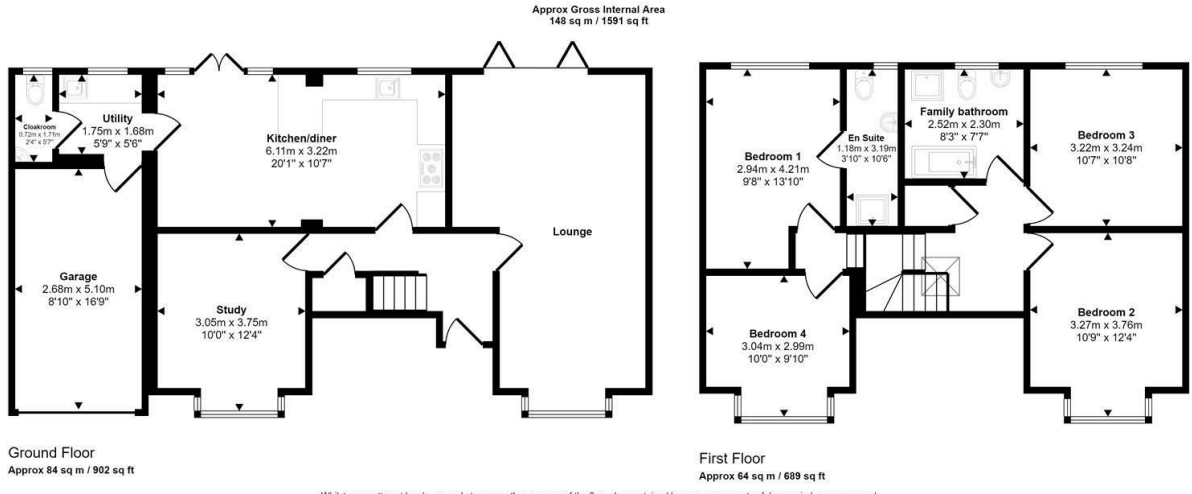

Whilst every attempt has been made to ensure the accuracy of the floor plan contained here, measurements of doors, windows, rooms and any other items are approximate and no responsibility is taken for any error, omission, or mis-statement. The measurements should not be relied upon for valuation, transaction and/or funding purposes. This plan is for illustrative purposes only and should be used as such by any prospective purchaser or tenant.

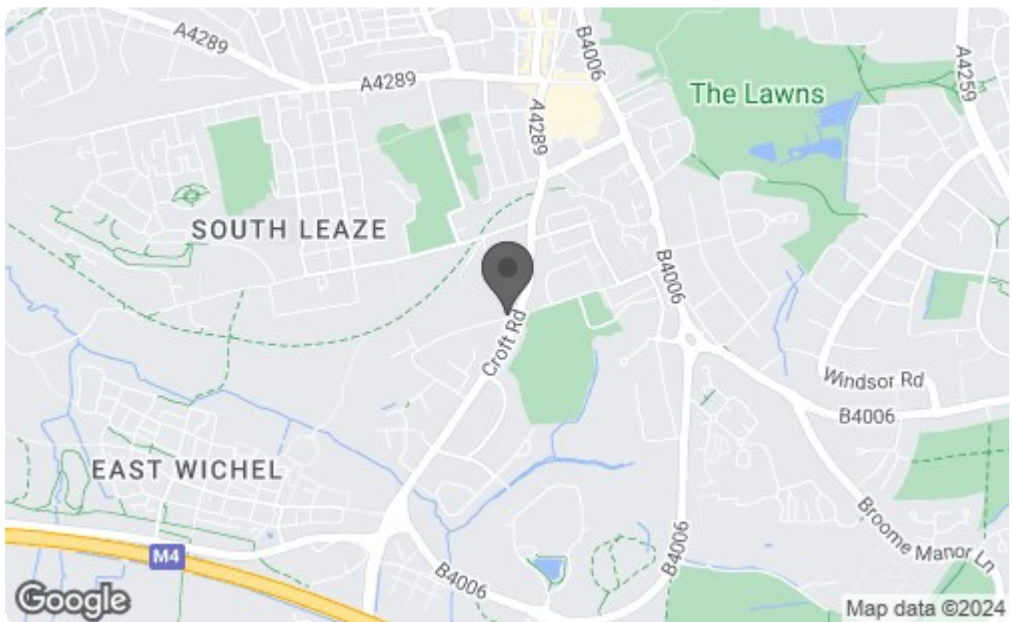

Energy Efficiency Rating		
	Current	Potential
Very energy efficient - lower running costs		
(92 plus) A		
(81-91) B		83
(69-80) C	68	
(55-68) D		
(39-54) E		
(21-38) F		
(1-20) G		
Not energy efficient - higher running costs		
England & Wales EU Directive 2002/91/EC		
Environmental Impact (CO ₂) Rating		
	Current	Potential
Very environmentally friendly - lower CO ₂ emissions		
(92 plus) A		
(81-91) B		
(69-80) C		
(55-68) D		
(39-54) E		
(21-38) F		
(1-20) G		
Not environmentally friendly - higher CO ₂ emissions		
England & Wales EU Directive 2002/91/EC		

